

CLB (KH) SERİSİ KOMPAKT LINEAR RULMANLAR

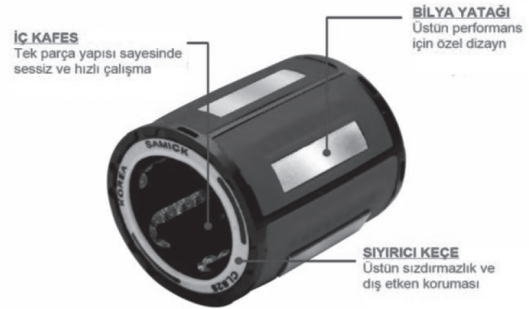
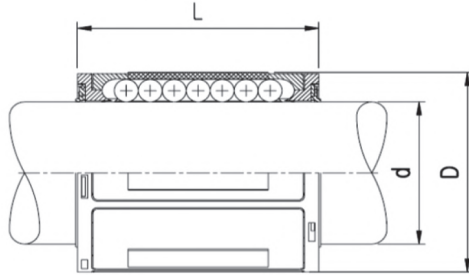

Parça No.		Ölçüler			İç Çap Boşluk (µm)	Yük Kapasitesi (N)		Sıyırıcı Keçesiz	Sıyırıcı Keçeli
Sıyırıcı Keçesiz	Sıyırıcı Keçeli	d (mm)	D (mm)	L (mm)		Dinamik (C)	Statik (C ₀)		
CLB 12	CLB 12 UU	12	19	28	+ 9 / -1	480	385		
CLB 14	CLB 14 UU	14	21	28		640	440		
CLB 16	CLB 16 UU	16	24	30		925	625		
CLB 20	CLB 20 UU	20	28	30		1165	790		
CLB 25	CLB 25 UU	25	35	40	+ 11 / -1	2100	1370		
CLB 30	CLB 30 UU	30	40	50		2870	2100		

SAMICK NO	INA NO	SKF NO	STAR NO	SAMICK NO	INA NO	SKF NO	STAR NO
CLB 12	KH 1228	LBBR 12	0658-012-00	CLB 12 UU	KH 1228 PP	LBBR 12-2LS	0658-212-40
CLB 14	KH 1428	LBBR 14	0658-014-00	CLB 14 UU	KH 1428 PP	LBBR 14-2LS	0658-214-40
CLB 16	KH 1630	LBBR 16	0658-016-00	CLB 16 UU	KH 1630 PP	LBBR 16-2LS	0658-216-40
CLB 20	KH 2030	LBBR 20	0658-020-00	CLB 20 UU	KH 2030 PP	LBBR 20-2LS	0658-220-40
CLB 25	KH 2540	LBBR 25	0658-025-00	CLB 25 UU	KH 2540 PP	LBBR 25-2LS	0658-225-40
CLB 30	KH 3050	LBBR 30	0658-030-00	CLB 30 UU	KH 3050 PP	LBBR 30-2LS	0658-230-40

ATLIER

Rulmanlık Endüstriyel Ekipman Tic. ve San. Ltd. Şti.



KAPALI TİP	İÇ	DIŞ	EN
LME 5 UU	5	12	22
LME 8 UU	8	16	25
LME 12 UU	12	22	32
LME 16 UU	16	26	36
LME 20 UU	20	32	45
LME 25 UU	25	40	58
LME 30 UU	30	47	68
LME 40 UU	40	62	80
LME 50 UU	50	75	100
LME 60 UU	60	90	125



KAPALI TİP	İÇ	DIŞ	EN
LM 5 UU	5	10	15
LM 6 UU	6	12	19
LM 8 UU	8	15	24
LM 10 UU	10	19	29
LM 12 UU	12	21	30
LM 13 UU	13	23	32
LM 16 UU	16	28	37
LM 20 UU	20	32	42
LM 25 UU	25	40	59
LM 30 UU	30	45	64
LM 35 UU	35	52	70
LM 40 UU	40	60	80
LM 50 UU	50	80	100
LM 60 UU	60	90	110
LM 80 UU	80	120	140



AÇIK TİP	İÇ	DIŞ	EN
LME 12 UUOP	12	22	32
LME 16 UUOP	16	26	36
LME 20 UUOP	20	32	45
LME 25 UUOP	25	40	58
LME 30 UUOP	30	47	68
LME 40 UUOP	40	62	80
LME 50 UUOP	50	75	100
LME 60 UUOP	60	90	125



AÇIK TİP	İÇ	DIŞ	EN
LM 16 UU OP	16	28	37
LM 20 UU OP	30	32	42
LM 25 UU OP	25	40	59
LM 30 UU OP	30	45	64
LM 40 UU OP	40	60	80
LM 50 UU OP	50	80	100
LM 60 UU OP	60	90	125



AYARLI TİP	İÇ	DIŞ	EN
LME 5 UUAJ	5	12	22
LME 8 UUAJ	8	22	25
LME 12 UUAJ	12	22	32
LME 16 UUAJ	16	26	36
LME 20 UUAJ	20	32	45
LME 25 UUAJ	25	40	58
LME 30 UUAJ	30	47	68
LME 40 UUAJ	40	62	80
LME 50 UUAJ	50	75	100
LME 60 UUAJ	60	90	125



UZUN TİP	İÇ	DIŞ	EN
LME 08 LUU	8	16	45
LME 12 LUU	12	22	57
LME 16 LUU	16	26	70
LME 20 LUU	20	32	80
LME 25 LUU	25	40	112
LME 30 LUU	30	47	123
LME 40 LUU	40	62	154
LME 50 LUU	50	75	192
LME 60 LUU	60	90	211

"SUPERBALL" STANDART RULMANLARDAN 3 KAT DAHA FAZLA YÜK, 27 KAT DAHA FAZLA ÖMÜR.



TİP	İÇ	DIŞ	EN	Kapalı	Açık-OP
LMES 10 UU	10	19	29		
LMES 12 UU	12	22	32		
LMES 16 UU	16	26	36		
LMES 20 UU	20	32	45		
LMES 25 UU	25	40	58		
LMES 30 UU	30	47	68		
LMES 40 UU	40	62	80		
LMES 50 UU	50	75	100		

TİP	İÇ	DIŞ	EN	Kapalı	Açık-OP
LMBS 06 UU	9,5	15,8	22,2		
LMBS 08 UU	12,7	22,2	31,7		
LMBS 10 UU	15,8	25,8	38,1		
LMBS 12 UU	19,0	31,7	41,2		
LMBS 16 UU	25,4	39,6	57,1		
LMBS 20 UU	31,7	50,8	66,6		
LMBS 24 UU	38,1	60,3	76,2		
LMBS 32 UU	50,8	76,2	101,6		



YUVARLAK FL.	İÇ	DIŞ	BOY
LMEF 08 UU	8	16	25
LMEF 12 UU	12	22	32
LMEF 16 UU	16	26	36
LMEF 20 UU	20	32	45
LMEF 25 UU	25	40	58
LMEF 30 UU	30	47	68
LMEF 40 UU	40	62	80
LMEF 50 UU	50	75	100
LMEF 60 UU	60	90	125



KARE FLANŞ	İÇ	DIŞ	BOY	FİYAT
LMEK 08 UU	8	16	25	
LMEK 12 UU	12	22	32	
LMEK 16 UU	16	26	36	
LMEK 20 UU	20	32	45	
LMEK 25 UU	25	40	58	
LMEK 30 UU	30	47	68	
LMEK 40 UU	40	62	80	
LMEK 50 UU	50	75	100	
LMEK 60 UU	60	90	125	



YUVARLAK UZUN	İÇ	DIŞ	BOY
LMEF 16 LUU	16	26	70
LMEF 20 LUU	20	32	80
LMEF 25 LUU	25	40	112
LMEF 30 LUU	30	47	123
LMEF 40 LUU	40	62	154
LMEF 50 LUU	50	75	192
LMEF 60 LUU	60	90	211



KARE FLANŞ UZUN	İÇ	DIŞ	BOY
LMEK 16 LUU	16	26	70
LMEK 20 LUU	20	32	80
LMEK 25 LUU	25	40	112
LMEK 30 LUU	30	47	123
LMEK 40 LUU	40	62	154
LMEK 50 LUU	50	75	192
LMEK 60 LUU	60	90	211



KARE FLANŞ	İÇ	DIŞ	BOY
LMK 12 UU	12	21	30
LMK 16 UU	16	28	37
LMK 20 UU	20	32	42
LMK 25 UU	25	40	59
LMK 30 UU	30	45	64
LMK 40 UU	40	60	80
LMK 60 UU	60	90	110
LMK 80 UU	80	120	140



KARE FLANŞ UZUN	İÇ	DIŞ	BOY
LMK 10 LUU	10	19	55
LMK 12 LUU	12	21	57
LMK 16 LUU	16	28	70
LMK 20 LUU	20	32	80
LMK 25 LUU	25	40	112
LMK 30 LUU	30	45	123
LMK 40 LUU	40	60	154



KARE FLANŞ	İÇ	DIŞ	BOY
LMH 12 UU	12	21	30
LMH 16 UU	16	28	37
LMH 20 UU	20	32	42
LMH 25 UU	25	40	59
LMH 30 UU	30	45	64



KARE FLANŞ UZUN	İÇ	DIŞ	BOY
LMH 12 LUU	12	21	57
LMH 16 LUU	16	28	70
LMH 20 LUU	20	32	80
LMH 25 LUU	25	40	112
LMH 30 LUU	30	45	123

ATLIER

Rulmanlık Endüstriyel Ekipman Tic. ve San. Ltd. Şti.

PARÇA NO.	W (EN)	L (BOY)	H (YÜKSEKLİK)
SCE 08 UU	34	30	22
SCE 12 UU	44	39	30
SCE 16 UU	50	44	38,5
SCE 20 UU	54	50	41
SCE 25 UU	76	67	51,5
SCE 30 UU	78	72	59,5
SCE 40 UU	102	90	78
SCE 50 UU	122	110	102

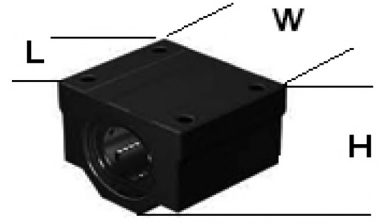

PARÇA NO.	W (EN)	L (BOY)	H (YÜKSEKLİK)
SCE 8 VUU	34	15,4	22
SCE 12 VUU	44	20,5	30
SCE 16 VUU	50	23,5	38,5
SCE 20 VUU	54	27,4	41
SCE 25 VUU	76	37,4	51,5
SCE 30 VUU	78	40,9	59,5
SCE 40 VUU	102	56,4	78
SCE 50 VUU	122	68,9	102



PARÇA NO.	W (EN)	L (BOY)	H (YÜKSEKLİK)
SCE 12 WUU	44	77	30
SCE 16 WUU	50	89	38,5
SCE 20 WUU	54	106	41
SCE 25 WUU	76	136	51,5
SCE 30 WUU	78	154	59,5
SCE 40 WUU	102	180	78
SCE 50 WUU	122	230	102



PARÇA NO.	W (EN)	L (BOY)	H (YÜKSEKLİK)
SCJ 10 UU	40	35	26
SCJ 12 UU	44	39	30
SCJ 16 UU	50	44	38,5
SCJ 20 UU	54	50	41
SCJ 25 UU	76	67	51,5
SCJ 30 UU	78	72	59,5
SCJ 35 UU	90	80	68
SCJ 40 UU	102	90	78
SCJ 50 UU	122	110	102



MİL UÇ BAĞLANTILARI

PARÇA NO	h	H	C	W
SK 08	20	32,8	32	42
SK 12	23	38	32	42
SK 13	23	38	32	42
SK 16	27	44	38	48
SK 20	31	51	45	60
SK 25	35	60	56	70
SK 30	42	70	64	84
SK 40	60	96	90	114
SK 50	70	120	100	126

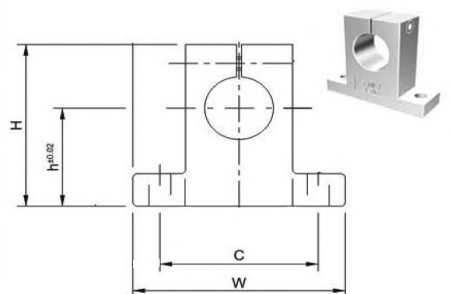

ATLIER

Rulmançılık Endüstriyel Ekipman Tic. ve San. Ltd. Şti.

SBR

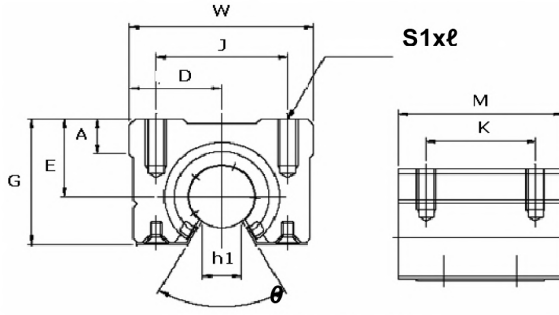

PARÇA NO	FİYAT	Ölçüler (mm)											Yük Kapasitesi(N)	
		D	W	G	θ	A	M	S1xℓ	h1	E	J	K	Dinamik	Statik
SBR 16 UU		22,5	45	33	80°	9	45	M5x12	11	20	32	30	770	1170
SBR 20 UU		24	48	39	60°	11	50	M6x12	11	23	35	35	860	1370
SBR 25 UU		30	60	47	50°	14	65	M6x12	12	27	40	40	980	1560
SBR 30 UU		35	70	56	50°	15	70	M8x18	15	33	50	50	1560	2740
SBR 40 UU		45	90	72	50°	20	90	M10x20	20	42	65	65	2150	4010
SBR 50 UU		60	120	91	50°	25	110	M10x20	25	53	94	80	3820	7930

TBR

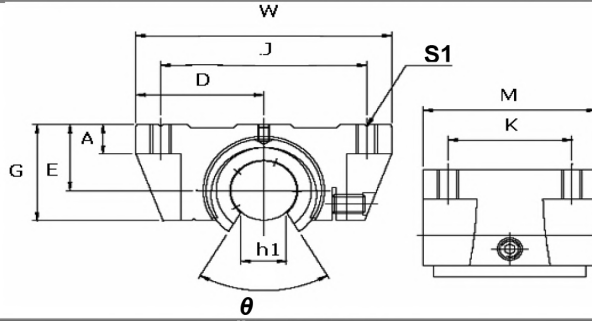

PARÇA NO	FİYAT	Ölçüler (mm)											Yük Kapasitesi(N)	
		D	W	G	θ	A	M	S1	h1	E	J	K	Dinamik	Statik
TBR 16 UU		31	62	26	80°	8	42	M5	11	18	50	30	392	490
TBR 20 UU		34	68	31	60°	10	51	M6	11	21	54	37	784	1176
TBR 25 UU		41	82	41	50°	12	65	M8	12	28	65	50	1568	2352
TBR 30 UU		45,5	91	48	50°	12	75	M8	15	34	75	60	1764	2940

SAC

ALT DESTEK + MİL KOMPLE

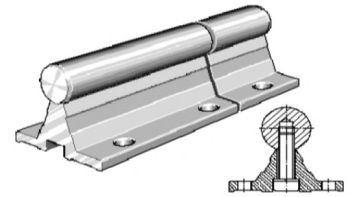
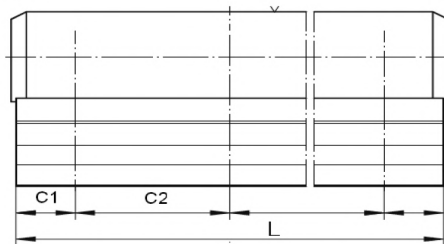
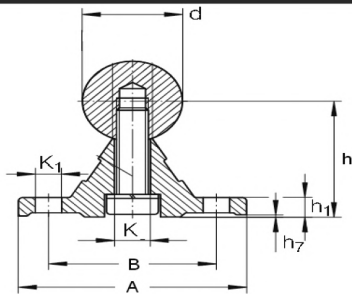

PARÇA NO	Ölçüler (mm)										
	h	B	A	d	h1	K1	K	h7	C1	C2	L _{max}
SAC 16-1000	26	33	45	16	5	5,5	5,5	0,2	50	100	6000
SAC 20-1000	32	37	52	20	6	6,6	6,6	0,2	50	100	6000
SAC 25-1000	36	42	57	25	6	6,6	9	0,3	60	120	6000
SAC 30-1000	42	51	69	30	7	9	11	0,3	75	150	6000
SAC 40-1000	50	55	73	40	8	9	11	0,3	100	200	6000
SAC 50-1000	55	55	73	50	8	9	11	0,3	100	200	6000

ÇELİK KAFESLİ METRİK SERİ

EASE NO.	IKO NO.	İÇ	DIŞ	EN
SDE 5	LME 51222	5	12	22
SDE 8	LME 81625	8	16	25
SDE 12	LME122232	12	22	32
SDE 16	LME162636	16	26	36
SDE 16 OP	LME162636OP	16	26	36
SDE 20	LME203245	20	32	45
SDE 20 OP	LME203245OP	20	32	45
SDE 25	LME254058	25	40	58
SDE 25 OP	LME254058OP	25	40	58
SDE 30	LME304768	30	47	68
SDE 30 OP	LME304768OP	30	47	68
SDE 40	LME406280	40	62	80
SDE 40 OP	LME406280OP	40	62	80
SDE 50	LME5075100	50	75	100
SDE 60	LME6090125	60	90	125
SDE 80	LME80120165	80	120	165

SDM 6	LM 61219	6	12	19
SDM 8S	LM 81517	8	15	17
SDM 8	LM 81524	8	15	24
SDM 10	LM101929	10	19	29
SDM 12	LM122130	12	21	30
SDM 13	LM132332	13	23	32
SDM 16	LM162837	16	28	37
SDM 20	LM203242	20	32	42
SDM 25	LM254059	25	40	59
SDM 30	LM304564	30	45	64
SDM 35	LM355270	35	52	70
SDM 40	LM406080	40	60	80
SDM 50	LM5080100	50	80	100
SDM 60	LM6090110	60	90	110
SDM 80	LM80120140	80	120	140
SDM 100	LM100150175	100	150	175

FİBER KAFESLİ METRİK SERİ

EASE NO.	IKO NO.	İÇ	DIŞ	EN
SDE 8 YUU	LBE 8 UU	8	16	25
SDE 12 YUU	LBE 12 UU	12	22	32
SDE 16 YUU	LBE 16 UU	16	26	36
SDE 20 YUU	LBE 20 UU	20	32	45
SDE 25 YUU	LBE 25 UU	25	40	58
SDE 30 YUU	LBE 30 UU	30	47	68
SDE 40 YUU	LBE 40 UU	40	62	80

SDM 6 YUU	LBD 6 UU	6	12	19
SDM 8SYUU	LBD 8SUU	8	15	17
SDM 8 YUU	LBD 8 UU	8	15	24
SDM 10 YUU	LBD 10 UU	10	19	29
SDM 12 YUU	LBD 12 UU	12	21	30
SDM 13 YUU	LBD 13 UU	13	23	32
SDM 16 YUU	LBD 16 UU	16	28	37
SDM 20 YUU	LBD 20 UU	20	32	42
SDM 25 YUU	LBD 25 UU	25	40	59
SDM 30 YUU	LBD 30 UU	30	45	64
SDM 35 YUU	LBD 35 UU	35	52	70
SDM 40 YUU	LBD 40 UU	40	60	80

ÇELİK KAFESLİ İNÇ SERİ

SDB 4	LMB4812	6,4	12,7	19,1
SDB 6	LMB61014	9,5	15,9	22,2
SDB 8	LMB81420	12,7	22,2	31,7
SDB 10	LMB101824	15,9	28,6	38,1
SDB 12	LMB122026	19,1	31,7	41,2
SDB 16	LMB162536	25,4	39,6	57,1
SDB 20	LMB203242	31,8	50,8	66,7
SDB 24	LMB243848	38,1	60,3	76,2
SDB 32	LMB324864	50,8	76,2	101,6
SDB 40	LMB406080	63,5	95,2	127,0
SDB 48	LMB487296	76,2	114,3	152,4
SDB 64	LMB6496128	101,6	152,4	203,2



ATLIER

Rulmanlık Endüstriyel Ekipman Tic. ve San. Ltd. Şti.

KH SERİSİ ÖLÇÜLERİNDE METRİK SERİ

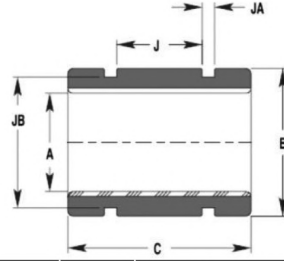

PARÇA NO	A	B	C	J	JA	JB	MAXIMUM YÜK KG.
FMT 6 KH 0622	6	12	22				278
FMT 8 KH 0824	8	15	24	10	2,00	12,2	404
FMT 10 KH 1026	10	17	26	12	2,00	14,4	546
FMT 12 KH 1228	12	19	28	14	2,00	16,6	706
FMT 14 KH 1428	14	21	28	14	2,00	18,5	824
FMT 16 KH 1630	16	24	30	14	2,00	21,3	1008
FMT 20 KH 2030	20	28	30	14	2,00	25,5	1260
FMT 25 KH 2540	25	35	40	22	3,20	30,9	2100
FMT 30 KH 3050	30	40	50	30	3,20	35,9	3150
FMT 40 KH 4060	40	52	60	40	4,10	46,2	5040
FMT 50 KH 5070	50	62	70	50	4,10	56,3	7350

- * Pürüzsüz ve sessiz hareket ile vibrasyon önleyici.
- * Frelon GOLD ile standart bilyalı burçlardan 20 kat daha fazla yük kapasitesi.
- * Şok yükler parçalara zarar vermeden absorbe edilebilme.
- * Daha düşük aşınma.
- * Farklı ısı değerlerinde çalışma. (-240 C / +260 C)
- * Yağ keçesi gerektirmez.

LBE SERİSİ ÖLÇÜLERİNDE METRİK SERİ

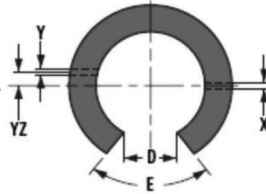
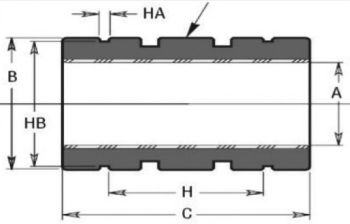

PARÇA NO	A	B	C	H	HA	HB	D	E	Max. Statik Yük (Kg.)
KAPALI AÇIK (OP)									
FM 5 FMN 5	5	12	22	12	1,14	11,5	3,2	60	232
FM 8 FMN 8	8	16	25	14	1,14	15,2	5,1	60	420
FM 10 FMN 10	10	19	29	19,4	1,32	18,0	6,4	60	610
FM 12 FMN 12	12	22	32	20	1,32	21,0	7,6	78	806
FM 16 FMN 16	16	26	36	22	1,32	24,9	10,4	78	1210
FM 20 FMN 20	20	32	45	28	1,63	30,3	10,8	60	1890
FM 25 FMN 25	25	40	58	40	1,90	37,5	13,2	60	3046
FM 30 FMN 30	30	47	68	48	1,90	44,5	14,2	72	4284
FM 40 FMN 40	40	62	80	56	2,20	59,0	19,5	72	6720
FM 50 FMN 50	50	75	100	72	2,70	72,0	24,0	72	10500
FM 60 FMN 60	60	90	125	95	3,20	86,4	29,6	72	15750
FM 80 FMN 80	80	120	165	125	4,17	116,1	39,0	72	27720
FJ 20 FJN 20	20	32	42	27,2	1,65	30,3	11	60	1890
FJ 25 FJN 25	25	40	59	37,2	1,85	38,0	12	50	3046
FJ 30 FJN 30	30	45	64	40,7	1,85	42,5	15	50	4284
FJ 40 FJN 40	40	60	80	56,1	2,20	57,0	20	50	6720

FM=LME FMN=LME..OP FJ=LM FJN=LM..OP

ATLIER

Rulmanlık Endüstriyel Ekipman Tic. ve San. Ltd. Şti.

KENDİNDEN YAĞLAMALI MİNYATÜR KIZAK VE ARABALAR



Hassasiyet Değeri
.025 - .051 mm
Seramik Kaplama

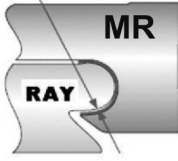

Hassasiyet Değeri
.064 - .089 mm
Seramik Kaplama



PARÇA NO

MR 7
MR 9
MR 12
MR 15
MR 20

V-GUIDE SİSTEM RM RULMANLAR İÇİN RAYLAR

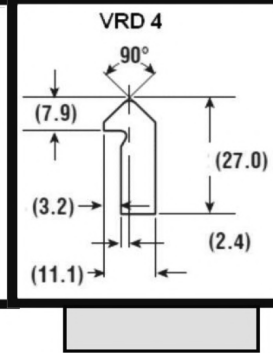
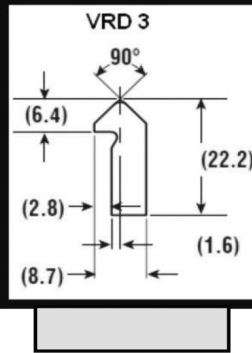
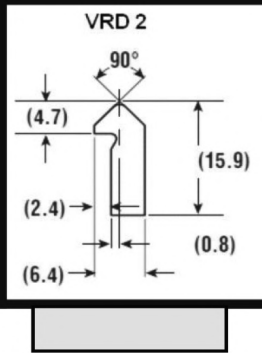
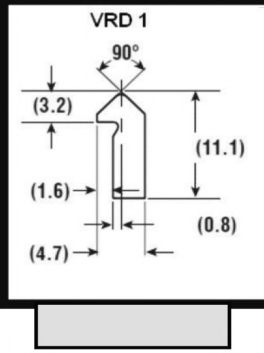

KENDİNDEN YAĞLAMALI LINEAR KIZAK VE ARABALAR

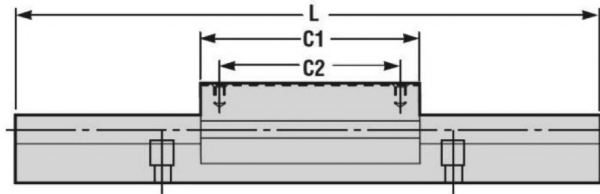
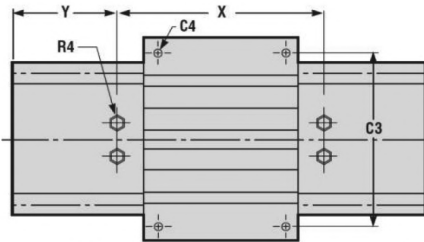
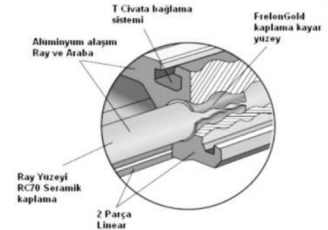
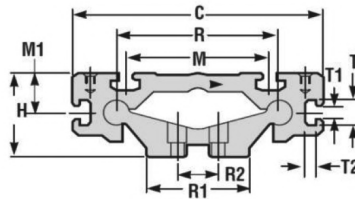

Ölçüler mm

Parça No.	R	R1	R2	X	R4	Y	H	C	C1	C2	C3	C4	M	M1
DLM075C	75	51	20	120	M 6	60	41,3	117	85	73	105	M 5	66	16,5
DLM100C	100	66	25	150	M 8	75	54	155	115	95	135	M 6	89	26
DLM125C	125	84	30	200	M 10	100	66,7	193	150	130	175	M 8	110	33

ATLIER

Rulmanlık Endüstriyel Ekipman Tic. ve San. Ltd. Şti.